

# QUILTED IN HONOR

by **Island Batik**



*Jacquie Gering's*

## FOR LOVE OF COUNTRY



Designer: Jacquie Gering

For Love of Country  
Size 63.5" x 66.5"



# For Love of Country

Finished Size 63 ½" x 66 ½"

Designed by **Jacque Gering**  
Tallgrass Prairie Studio

Quilted in Honor to Benefit  
Operation Homefront

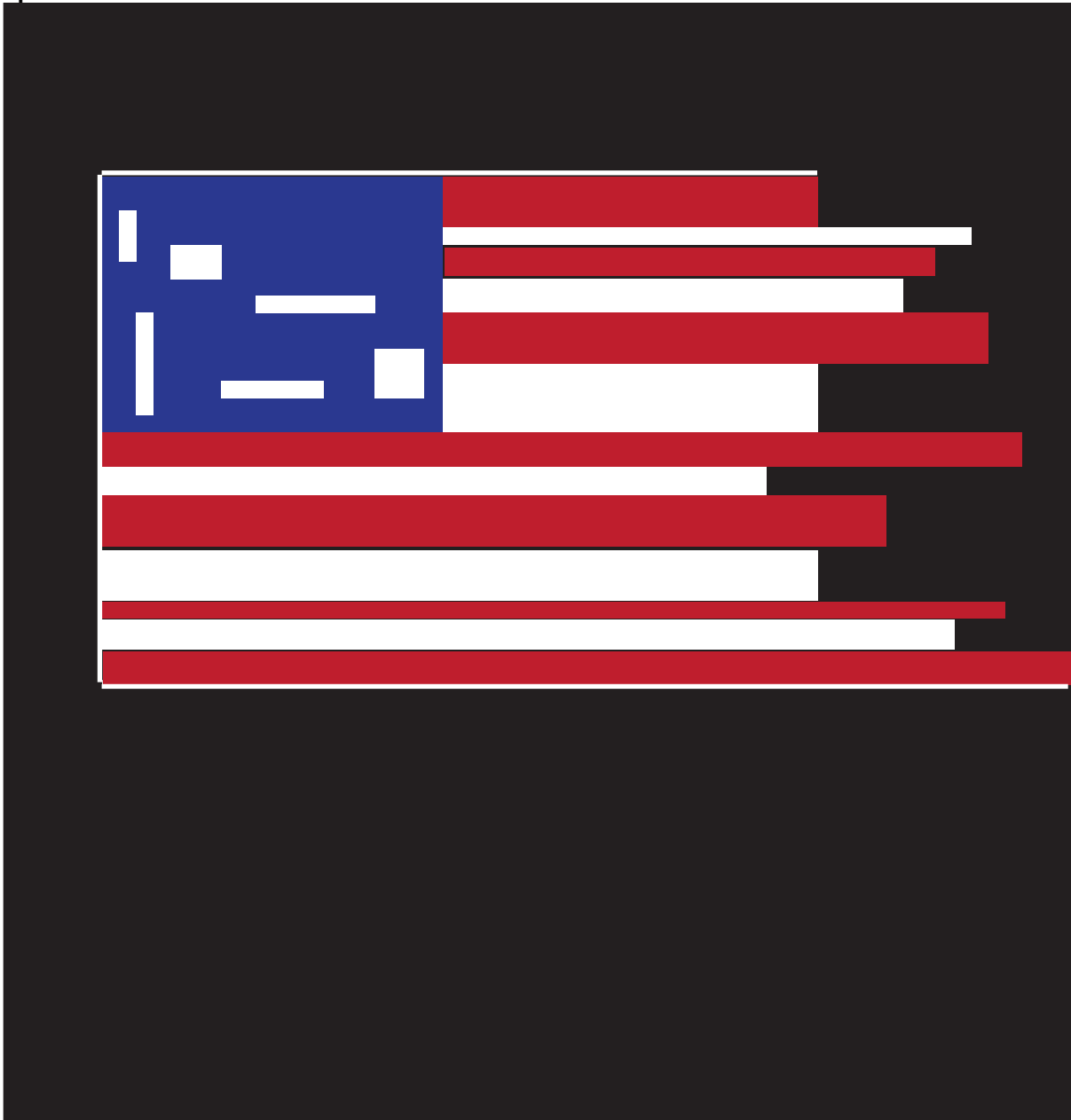

## Fabric Requirements

Fabrics		Yardage
Red	*US06-1	$\frac{3}{4}$ yard
White	*US03-4	$\frac{3}{4}$ yard
Blue	*US07-6	$\frac{1}{2}$ yard
Black	* BE14-6B	2 $\frac{2}{3}$ yards
Binding	* BE14-6B	$\frac{1}{2}$ yard
Backing	*US06-1	4 yards
Batting (low loft cotton)		72" x 75"

(\*Island Batik Quilted in Honor Fabrics)

## Cutting

Cut the pieces for each color and label each piece with sticky notes to keep your pieces organized.

### White

W1 1  $\frac{1}{2}$ " x 3  $\frac{1}{2}$ "

W2 (cut 2) 1  $\frac{1}{2}$ " x 6  $\frac{1}{2}$ "

W3 2  $\frac{1}{2}$  x 3  $\frac{1}{2}$ "

W4 1  $\frac{1}{2}$ " x 7  $\frac{1}{2}$ "

W5 3  $\frac{1}{2}$ " x 3  $\frac{1}{2}$ "

W6  $\frac{3}{4}$ " x 42  $\frac{3}{4}$ "

W7a  $\frac{3}{4}$ " x 42  $\frac{1}{2}$ " W7b  $\frac{3}{4}$ " x 15  $\frac{3}{4}$ " (to make a 57  $\frac{3}{4}$ " strip)

W8  $\frac{3}{4}$ " x 30  $\frac{1}{2}$ "

### WS (White Stripes)

WS1 1  $\frac{1}{2}$ " x 31  $\frac{1}{2}$ "

WS2 2  $\frac{1}{2}$  x 27  $\frac{1}{2}$ "

WS3 4  $\frac{1}{2}$  x 22  $\frac{1}{2}$ "

WS4 2  $\frac{1}{2}$ " x 39  $\frac{1}{2}$ "

WS5 3  $\frac{1}{2}$ " x 42  $\frac{1}{2}$ "

WS6a 2  $\frac{1}{2}$ " x 42  $\frac{1}{2}$ " WS6b 2  $\frac{1}{2}$ " x 8  $\frac{1}{2}$ " (to make a 50  $\frac{1}{2}$ " strip)

### Blue

B1 (cut 3) 1  $\frac{1}{2}$ " x 3  $\frac{1}{2}$ "

B2 2  $\frac{1}{2}$  x 3  $\frac{1}{2}$ "

B3 (cut 2) 2  $\frac{1}{2}$ " x 4  $\frac{1}{2}$ "

B4 (cut 3) 3  $\frac{1}{2}$ " x 4  $\frac{1}{2}$ "

B5 2 ½" x 6 ½"  
B6 1 ½" x 6 ½"  
B7 1 ½" x 4 ½"  
B8 3 ½" x 9 ½"  
B9 7 ½" x 13 ½"  
B10 1 ½" x 2 ½"  
B11 4 ½" x 9 ½"  
B12 2 ½" x 9 ½"

### **RS (Red Stripes)**

RS1 3 ½" x 22 ½"  
RS2 2 ½" x 29 ½"  
RS3 3 ½" x 32 ½"  
RS4a 2 ½" x 42 ½" and RS4b 2 ½" x 12 ½" (to make a 54 ½" strip)  
RS5a 3 ½" x 42 ½" and RS5b 3 ½" x 4 ½" (to make a 46 ½" strip)  
RS6a 1 ½" x 42 ½" and RS6b 1 ½" x 11 ½" (to make a 53 ½" strip)  
RS7a 2 ½" x 42 ½" and RS7b 2 ½" x 15 ½" (to make a 57 ½" strip)

### **Black Background**

BK1 3 ½" x 15 ½"  
BK2 1 ½" x 6 ½"  
BK3 2 ½" x 8 ½"  
BK4 2 ½" x 10 ½"  
BK5 3 ½" x 5 ½"  
BK6 4 ½" x 15 ½"  
BK7 2 ½" x 3 ½"  
BK8 2 ½" x 18 ½"  
BK9 3 ½" x 11 ½"  
BK10 3 ½" x 15 ½"  
BK11 1 ½" x 4 ½"  
BK12 2 ½" x 7 ½"  
BK13 6 ½" x 30 ½"  
BK14a 9 ½" x 42 ½" BK14b 9 ½" x 21 ½" (to make a 63 ½" strip)  
BK15 26 ½" x 42 ½" BK15b 26 ½" x 21 ½" (to make a 63 ½" strip)  
BK16 ¾" x 15 ½"

Binding (7) 2 ¼" x width of fabric strips

## Construction

### Construct the Star Field

All seams are a scant quarter inch and are pressed open unless otherwise indicated. Use the section diagrams as a guide for sewing.

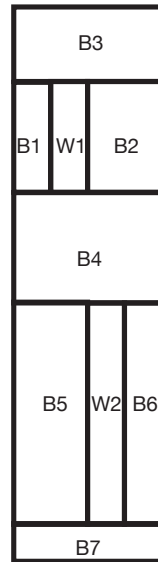

SECTION 1



SECTION 2

#### Section 1

- Sew B1 to the left side and B2 to the right side of W1.
- Sew B3 to the top and B4 to the bottom of the section completed in Step a.
- Sew B5 to the left side and B6 to the right side of W2.
- Sew B7 to the bottom of the section completed in Step c.
- Sew the section completed in Step a/b to the top of the section completed in Step c/d to finish section 1.

#### Section 2

- Sew B4 to the top and B8 to the bottom of W3 to finish section 2.

#### Section 3

- Section 3 is piece B9.

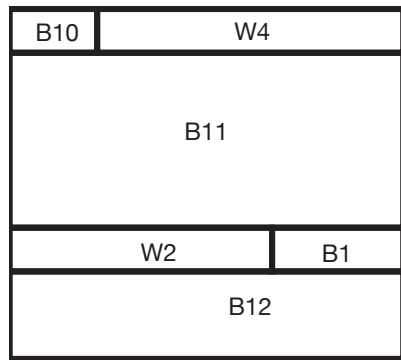

SECTION 4

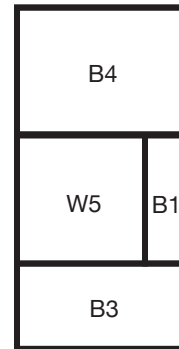

SECTION 5

#### Section 4

- Sew B10 to the left side of W4.
- Sew B11 to the bottom of the section completed in Step a.
- Sew B1 to the right side of W2.
- Sew B12 to the bottom of the section completed in Step c.
- Sew the section completed in Step a/b to the top of the section completed in Step c/d to finish section 4.

#### Section 5

- Sew B1 to the right side of W5.
- Sew B4 to the top and B3 to the bottom of the section completed in Step a to finish section 5.

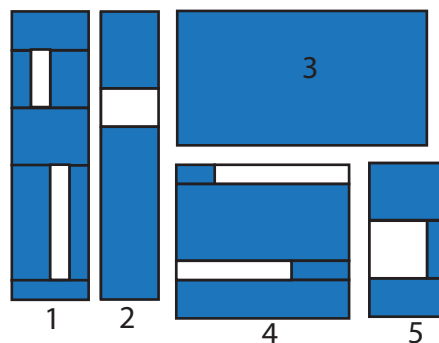

Star Field Sections

#### Combine Star Field Sections

Use the Star Field Section Diagram to guide your sewing.

- a. Sew Section 1 to Section 2.
- b. Sew Section 4 to Section 5.
- c. Sew Section 3 to the top of the 4/5 Section completed in Step b.
- d. Sew the completed 1/2 Section to the right side of the completed 3/4/5 Section to complete the star field. The completed section measures 15 ½ x 20 ½".

### Stripes Panel 1

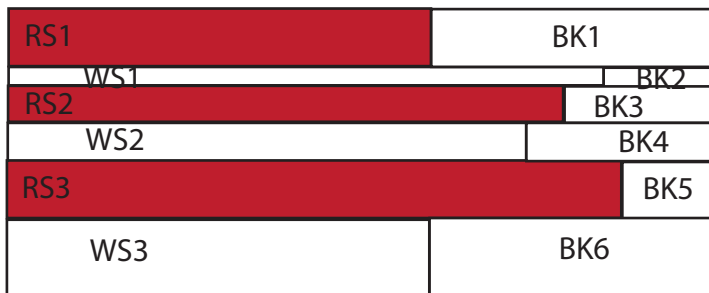

STRIPES PANEL 1

Use Stripes Panel 1 Diagram to guide your sewing. Sew each flag stripe to its corresponding background piece.

- a. Sew RS1 to BK1.
- b. Sew WS1 to BK2.
- c. Sew RS2 to BK3.
- d. Sew WS2 to BK4.
- e. Sew RS3 to BK5.
- f. Sew WS3 to BK6.
- g. Sew the stripes together in order from top to bottom as shown to finish Stripes Panel 1.

### Stripes Panel 2



STRIPES PANEL 2

Use Stripes Panel 2 Diagram to guide your sewing. Sew a and b pieces of RS4, RS5, RS6, RS7 and WS6 together to make the stripes Sew each flag strip to its corresponding background piece.

- a. Sew RS4 to BK7.
- b. Sew WS4 to BK8.
- c. Sew RS5 to BK9.
- d. Sew WS5 to BK10.
- e. Sew RS6 to BK11.
- f. Sew WS6 to BK12.
- g. Sew the strips together in order from top to bottom. Sew RS7 to the bottom to complete stripes panel 2.

### **Assemble the flag.**

- a. Sew Stripes Panel 1 to the left side of the star field.
- b. Sew Stripes Panel 2 to the bottom of the section sewn in Step a.

### **Framing Strips**

- a. Sew W7a to W7b to make a  $57 \frac{3}{4}$ " strip.
- b. Sew W6 to BK16.
- c. Sew W8 to the left side of the flag.
- d. Sew the strip made in Step a to the bottom of the flag.
- e. Sew the strip made in Step b to the top of the flag.

### **Borders**

- a. Sew BK 13 to the left side of the flag.
- b. Sew BK14a to BK14b and then sew the border to the top of the flag.
- c. Sew BK15a to BK15b and then sew the border to the bottom of the flag.

### **Finishing**

- a. Cut two pieces of backing fabric 72" x 38" and sew them together using a  $\frac{1}{2}$ " seam along the 72" sides to make the back.
- b. Make a quilt sandwich with the quilt top, batting and backing and baste using your preferred method.
- c. Quilt as desired.
- d. Join the seven binding strips to create a continuous binding strip. Machine-sew the binding to the front of the quilt. Hand-sew the binding to the back of the quilt.